

Overview

Wall mount control panel for DME series with LCD screen. Easy connection by Ethernet CAT5, PoE adaptor included



Features

- Connects via Ethernet
- Functions include scene recall and six user-defined keys at the top and bottom of the LCD screen, which can be assigned to DME parameters such as microphone and music source levels.
- Up to 4 sets of “pages” are available -giving up to 24 parameters.
- LCD display shows names and scenes and function keys in five languages - English, German, French, Spanish and Japanese.

General Specifications

Ethernet Terminals

(100Base-TX/10Base-T Ethernet, RJ-45)

Adaptor box to network

Pin	Connection
1	TxD+
2	TxD-
3	RxD+
4	Unused
5	Unused
6	RxD-
7	Unused
8	Unused

Control panel to adaptor box connection

Pin	Connection
1	TxD+
2	TxD-
3	RxD+
4	+16V
5	+16V
6	RxD-
7	GND
8	GND

Straight/Cross Cable Wiring Details

All pins are used on the straight cable connecting the control panel unit and adaptor box.

Straight Cables

Pins
1 — 1
2 — 2
3 — 3
4 — 4
5 — 5
6 — 6
7 — 7
8 — 8

Cross Cables

Pins
1 — 3
2 — 6
3 — 1
4 — 4
5 — 5
6 — 2
7 — 7
8 — 8

Control I/O Characteristics

Terminal	Format	Connector
Ethernet	100Base-TX/10Base-TX	RJ45

Net Weight

1Kg (2.2lbs)

Temperature Range

Conditions	Range
Operating temperature range	10 – 35°C
Storage temperature range	-20 – 60°C

Dimensions

Unit: mm (inch)

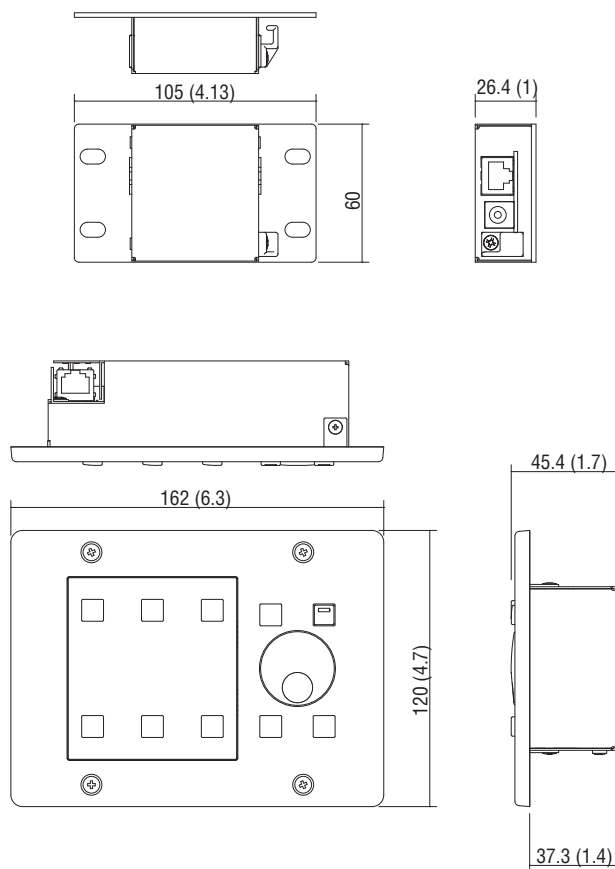

Software

- DME Designer

*All information subject to change without notice.

*All trademarks and registered trademarks are property of their respective owners.

Created in March, 2017

YAMAHA CORPORATION
P.O.BOX 1, Hamamatsu Japan
www.yamahaproaudio.com